



Lime Kiln Lane, Feltwell, Thetford, IP26 4BG

welcome to

Lime Kiln Lane, Feltwell THETFORD

A SPACIOUS and VERSATILE semi-detached bungalow in the SOUGHT AFTER VILLAGE of Feltwell, offering THREE BEDROOMS, master EN-SUITE, versatile living space, GARAGE, ample OFF ROAD PARKING and a GENEROUS GARDEN to rear!

Summary

Occupying a generous plot within the desirable Norfolk village of Feltwell, this spacious semi-detached bungalow offers flexible accommodation, excellent potential and a fantastic opportunity for families, downsizers or buyers seeking single-storey living.

Perfectly positioned within easy reach of the village's amenities, including a pub, shop and Post Office, takeaways and primary school, the property also enjoys convenient access to the nearby market town of Brandon, where you'll find supermarkets, further schooling, independent shops, restaurants and direct rail links to Cambridge & Norwich.

Set behind an impressive lawned frontage, the home immediately benefits from ample off road parking and a garage, providing practicality from the moment you arrive.

Inside, the accommodation is bright, well proportioned and highly versatile. A welcoming entrance hall leads to a spacious front aspect living room, where large windows flood the room with natural light, creating a warm and inviting place to relax. The modern fitted kitchen is well equipped for everyday living, while three generous bedrooms provide comfortable accommodation, with the principal bedroom enjoying the added luxury of an en-suite shower room.

A family bathroom serves the remaining bedrooms, while an additional hallway leads to a flexible room that could easily become a home office, playroom, hobby room or snug, adapting effortlessly to the needs of its new owners.

The Accommodation

Entrance door to:

Entrance Hall

With door to front, built in storage cupboard and radiator.

Living Room

With window to front and radiator.

Kitchen

With a range of fitted kitchen units at wall and base level with work surface over, inset sink unit with mixer tap and drainer over, breakfast bar, space and plumbing for dishwasher, integrated eye level double oven, integrated hob with extractor over, built in storage cupboard, window to side, door to side and radiator.

Inner Hall

With door to:

Office

With door to side and radiator.

Bedroom One

With built in wardrobe, window to rear and radiator.

En-Suite

With W.C, wash hand basin with mixer tap over and shower cubicle with shower attachment over.

Bedroom Two

With window to rear and radiator.

Bedroom Three

With window to front and radiator.





Family Bathroom

With W.C, wash hand basin with taps over, corner bath unit with mixer tap and shower attachment over, window to rear and radiator.

Outside

Front Garden

To the front of the property, there is a large lawned garden and ample space for off road parking, which also leads to:

Garage

With garage door to front, windows to side and door to side.

Rear Garden

To the rear, the enclosed garden is also largely laid to lawn.



view this property online williamhbrown.co.uk/Property/BRD111319



welcome to

Lime Kiln Lane, Feltwell, Thetford

- Popular Feltwell Village Location
- Spacious Semi-Detached Bungalow
- Three Good Sized Bedrooms
- Master En-Suite & Family Bathroom
- Versatile Office, Playroom or Hobby Room
- Garage & Ample Off Road Parking
- Generous Rear Garden
- Close to Both Village & Town Amenities

Tenure: Freehold EPC Rating: E

Council Tax Band: B

£240,000

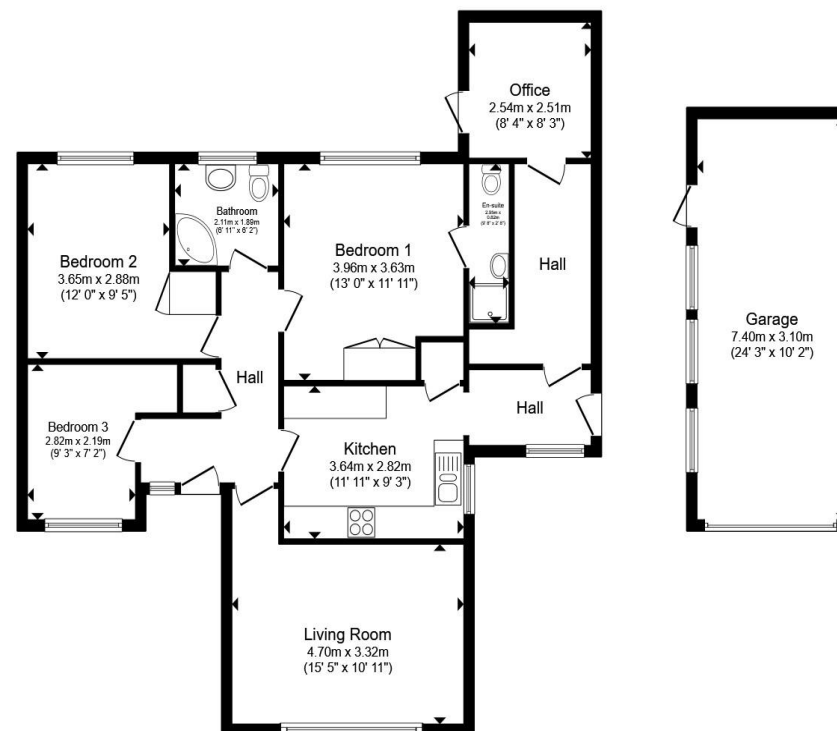

Floor Plan

Garage

Total floor area 116.8 m² (1,258 sq.ft.) approx

This floor plan is for illustrative purposes only. It is not drawn to scale. Any measurements, floor areas (including any total floor area), openings and orientation are approximate. No details are guaranteed, they cannot be relied upon for any purpose and they do not form part of any agreement. No liability is taken for any error, omission or misstatement. A party must rely upon its own inspection(s). Powered by www.propertybox.io



view this property online williamhbrown.co.uk/Property/BRD111319



Property Ref:
BRD111319 - 0002

1. MONEY LAUNDERING REGULATIONS Intending purchasers will be asked to produce identification documentation at a later stage and we would ask for your co-operation in order that there is no delay in agreeing the sale. 2. These particulars do not constitute part or all of an offer or contract. 3. The measurements indicated are supplied for guidance only and as such must be considered incorrect. Potential buyers are advised to recheck measurements before committing to any expense. 4. We have not tested any apparatus, equipment, fixtures or services and it is in the buyers interest to check the working condition of any appliances. 5. Where an EPC, or a Home Report (Scotland only) is held for this property, it is available for inspection at the branch by appointment. If you require a printed version of a Home Report, you will need to pay a reasonable production charge reflecting printing and other costs. 6. We are not able to offer an opinion either written or verbal on the content of these reports and this must be obtained from your legal representative. 7. Whilst we take care in preparing these reports, a buyer should ensure that his/her legal representative confirms as soon as possible all matters relating to title including the extent and boundaries of the property and other important matters before exchange of contracts.

William H Brown is a trading name of Sequence (UK) Limited which is registered in England and Wales under company number 4268443, Registered Office is Cumbria House, 16-20 Hockliffe Street, Leighton Buzzard, Bedfordshire, LU7 1GN. VAT Registration Number is 500 2481 05.

william h brown



01842 811058



Brandon@williamhbrown.co.uk



18-20 High Street, BRANDON, Suffolk, IP27
0AQ



williamhbrown.co.uk