

# Frank Harris & Co.



## Bath Terrace, SE1

£2,000 pcm

A two bedroom apartment located on the third floor along Bath Terrace. This property has a separate kitchen, sash windows, high ceilings and is offered furnished.

Located close to both Elephant & Castle and Borough tube stations for travel to either the West End of the City. On the doorstep of Newington and Dickens Square Park.

- Two Double Bedrooms • One Bathroom • Sash Windows •
- High Ceilings • Separate Kitchen • Great Location •

# Frank Harris & Co.

- BL Boiler
- S Smoke Alarm
- CM Carbon Monoxide

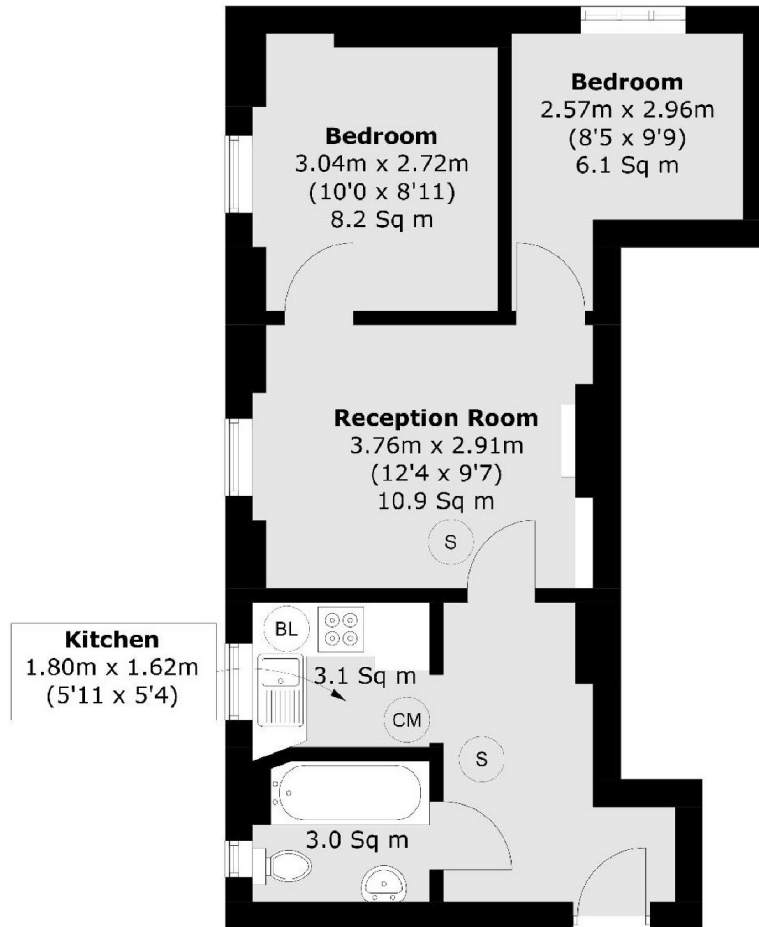

Total area (approx.): 40.3 sq. m (433.7 sq. ft)

Frank Harris & Co. Tower Bridge  
205 Tooley Street, London, SE1  
2JX  
020 7234 0880  
towerbridgelettings@frankharris.co.uk

Energy Rating: C. We aim to make our particulars both accurate and reliable. However they are not guaranteed; nor do they form part of an offer or contract. If you require clarification on any points then please contact us, especially if you're traveling some distance to view. Please note that appliances and heating systems have not been tested and therefore no warranties can be given as to their good working order.

