



For Sale

81 Grosvenor Road, Rugby

Offers Over £175,000

***** OPEN HOUSE ON SATURDAY 11TH JULY FROM 12N00N *****

-  **3**

-  **1**

-  **1**

-  **1765 sq ft**

 **678 sq ft**

Nathaniel Cleaver

07793 363210

nathaniel@thepropertyexperts.co.uk

TRADITIONAL MID TERRACE PROPERTY SITUATED IN POPULAR LOCATION & OFFERED FOR SALE WITH NO ONWARD CHAIN.

This mid terraced property is set in the popular area of Rugby and is close to all local amenities, shops, parks, schools and the train station.

In brief the ground floor consists of; entrance porch, living room with large window, kitchen / dining area and large conservatory.

Upstairs you have two double bedrooms and a box room which could be used as a nursery or study, there is also a white bathroom suite.

To the rear is the garden that has a patio area and lawn area and rear access. It also has the old outside WC, a storage cupboard and a single detached garage which is 19ft in length.

Further benefits are the fact it is gas centrally heated throughout, double glazed and it is close to all local amenities and schools and parks and is being offered for sale with no onward chain.

CALL NOW TO VIEW



The Property Experts UK

01926436105

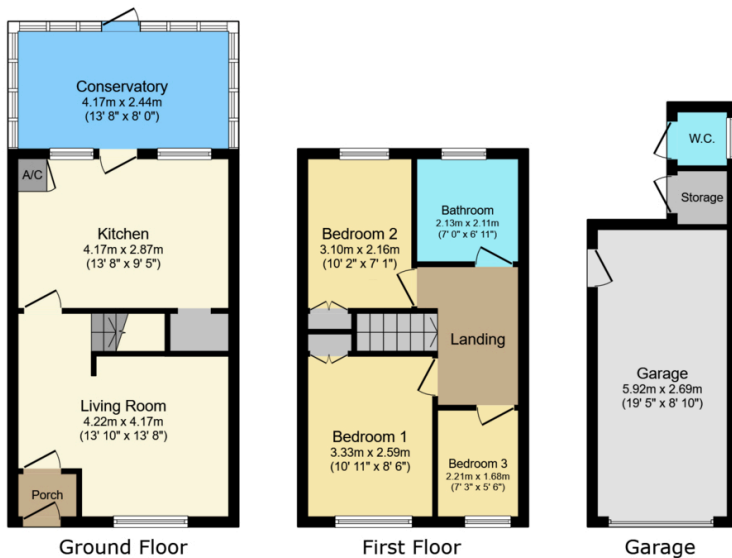

- Mid Terrace House
- Three Bedrooms
- Living Room
- Kitchen
- Large Conservatory
- Bathroom
- Single Detached Garage
- Close To Local Amenities
- No Onward Chain
- EPC Rating - C

Total floor area: 94.8 sq.m. (1,021 sq.ft.)

This floor plan is for illustrative purposes only. It is not drawn to scale. Any measurements, floor areas (including any total floor area), openings and orientations are approximate. No details are guaranteed, they cannot be relied upon for any purpose and do not form any part of any agreement. No liability is taken for any error, omission or misstatement. A party must rely upon its own inspection(s). Powered by www.Propertybox.io



Nathaniel Cleaver
 07793 363210
 nathaniel@thepropertyexperts.co.uk

